



ASSEMBLY GUIDE FOR Ledge® Mainstay Ultimate Adirondack



For a PDF version of these instructions, please scan the QR code.



Para instrucciones en español, por favor escanea este código QR.



Pour des instructions en français, veuillez scanner ce code QR.

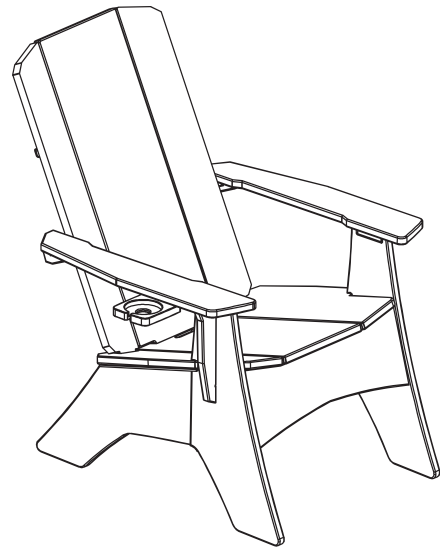

IMPORTANT NOTE

CAREFULLY READ ALL INSTRUCTIONS BEFORE STARTING. CRITICAL STEPS MIGHT BE MISSED RESULTING IN UNSUCCESSFUL ASSEMBLY OR DAMAGE TO THE PRODUCT.

WE RECOMMEND ASSEMBLING OVER A SOFT SURFACE SUCH AS A RUG OR CARPET TO AVOID SCRATCHES.

CONTENTS

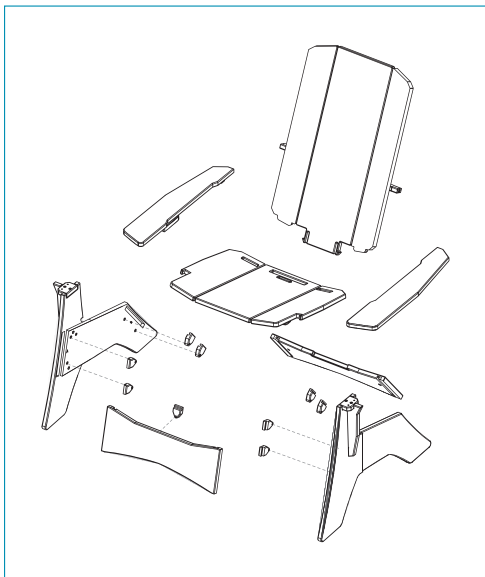

Left



Right

x2 Armrest

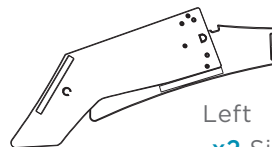

Left



Right

x2 Side Panel

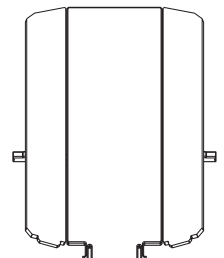

x1 Backrest

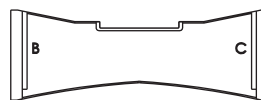

Front

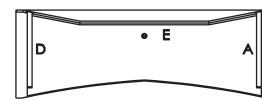

Back

x2 Base Panel

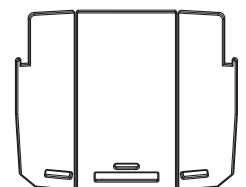

x1 Seat

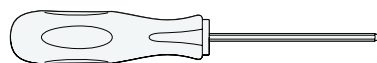

Hex Screwdriver



x9 Key

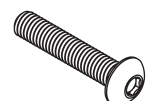

x19 Screw

ASSEMBLY

STEP 1: On each side panel, hinge the leg 90 degrees, and secure with two screws as shown in the graphic. Then, tighten the hinge screw.

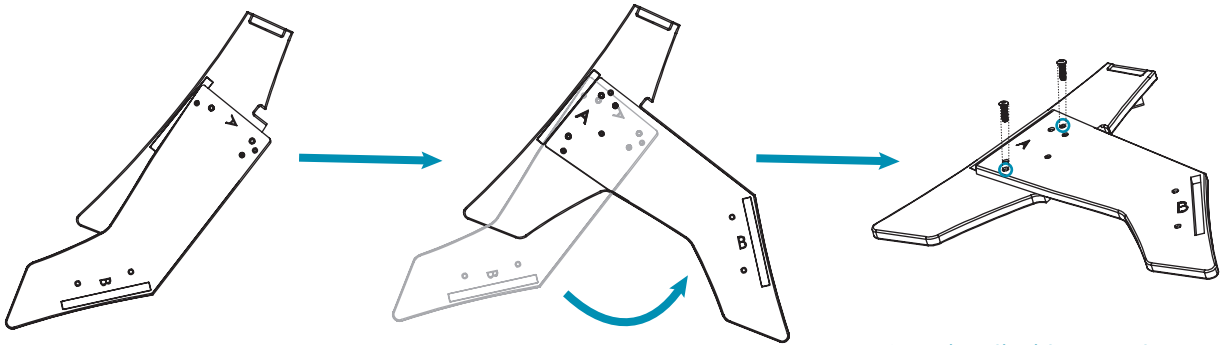

See detailed instructions on page 3.

STEP 2: Insert side A of the front panel into slot A on the right side panel. Then slide two keys into place and secure with a screw. There will be some flex until the base is fully assembled.

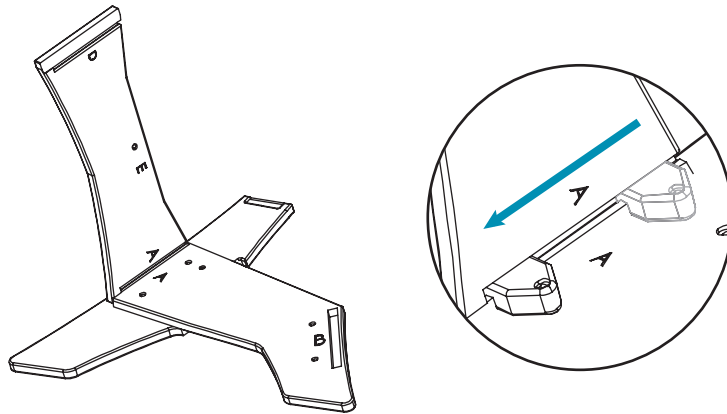

STEP 3: Insert side B of the back panel into slot B on the right side panel. Then slide two keys into place and secure with a screw.

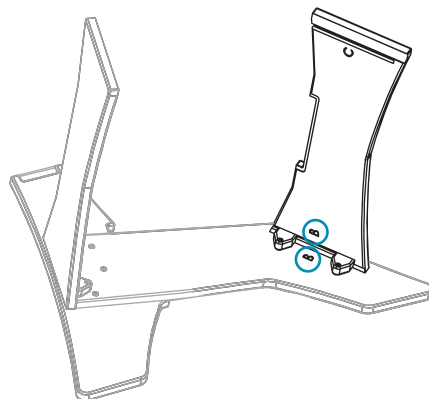

ENHANCED VIEW OF BOLT INSERTION POINTS

Use the included hex screwdriver to assist with locating and aligning the first bolt with the threaded insert in the bottom holes.

STEP 1: Gently insert hex screwdriver into hole. Slide and align. Then insert and tighten bolt.

NOTE: When you rotate the leg, make sure Insert Channel is parallel to the edge of the bottom chair leg.

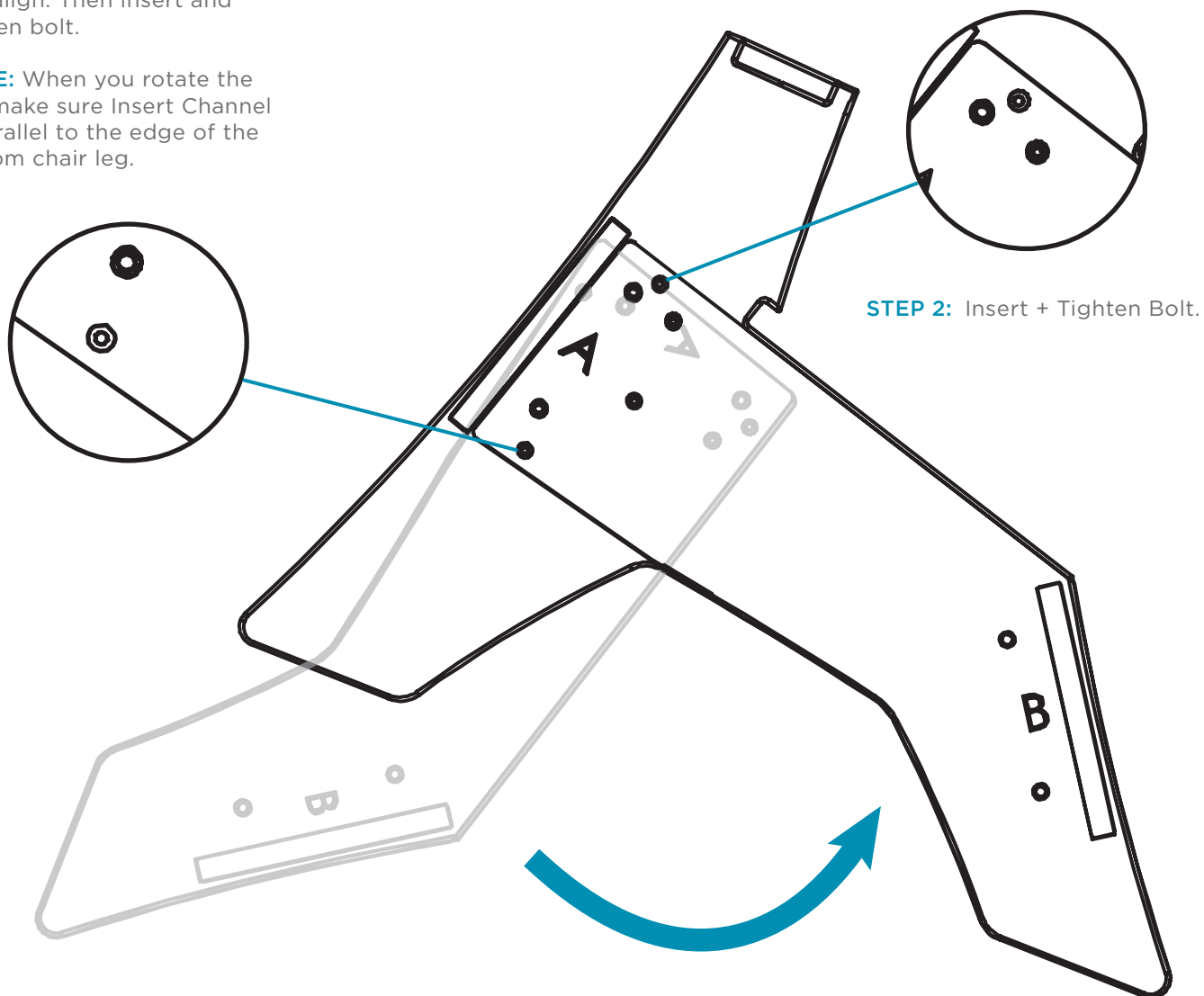

ASSEMBLY

STEP 4: Lift the assembled parts and slot onto the left side panel (C/D), making sure slots C and D match up. Then, secure with two keys as done on steps two and three.

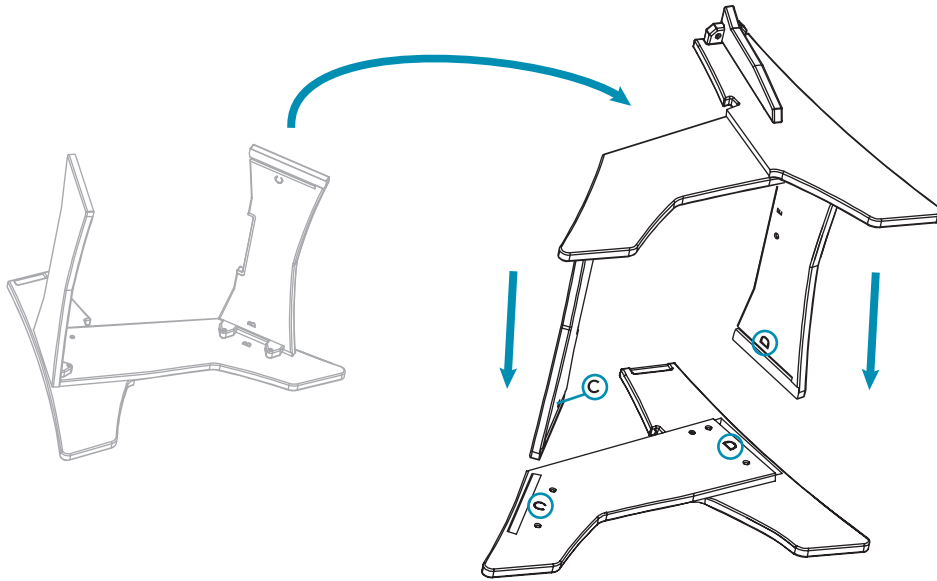

STEP 5: Lay the assembly on the ground with the back panel showing the letter E facing up. Grab the seat by the handle and lower it onto the slots on the side panels. Then, insert a key into slot E located on the underside of the seat, slide the key to the right, and screw it in place.

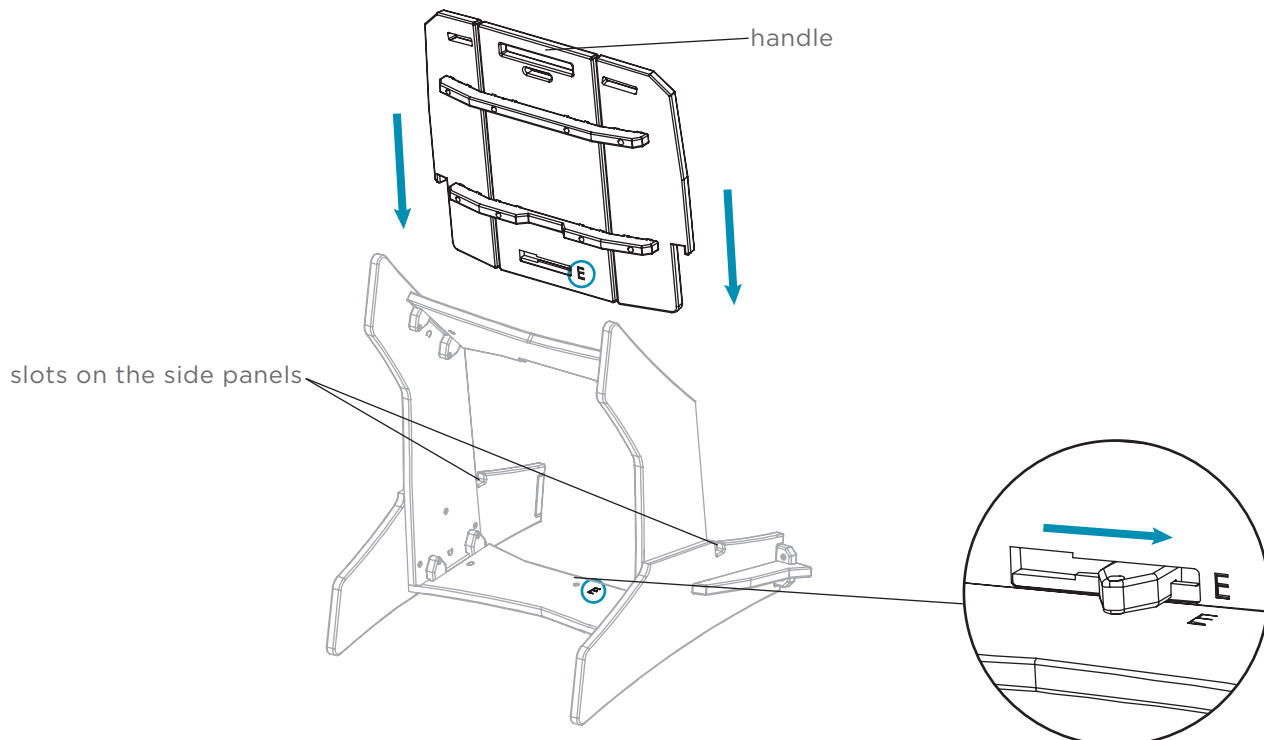

ASSEMBLY

STEP 6: Slot the back rest into place.

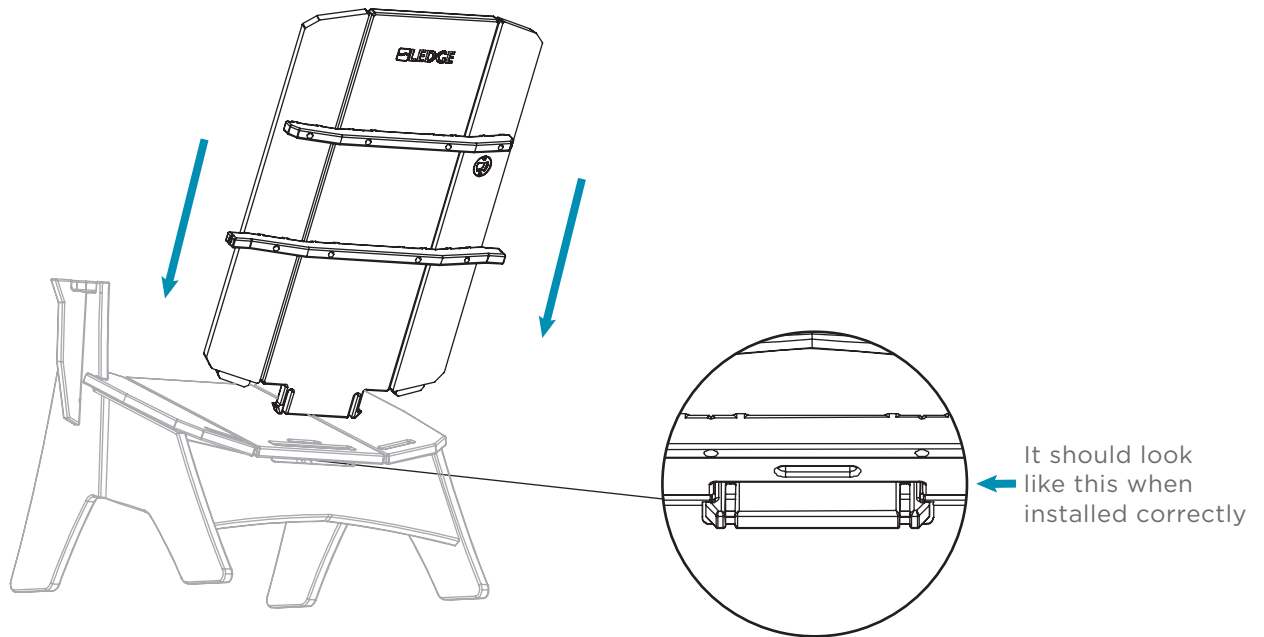

STEP 7: Attach the armrest by inserting the front 2 screws.

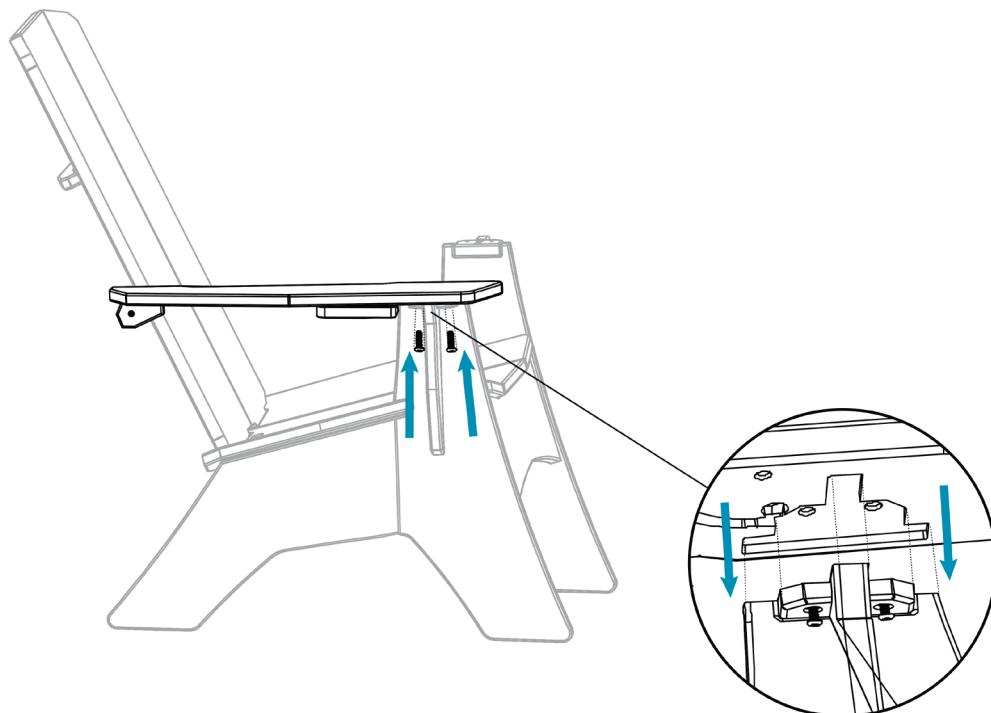

ASSEMBLY

STEP 8: Insert screw into the back of the arm rest and align it with the back rest. You may need to adjust the back rest angle to accommodate screw alignment. Fully tighten the back screw.

Repeat steps 7 and 8 on the other side.

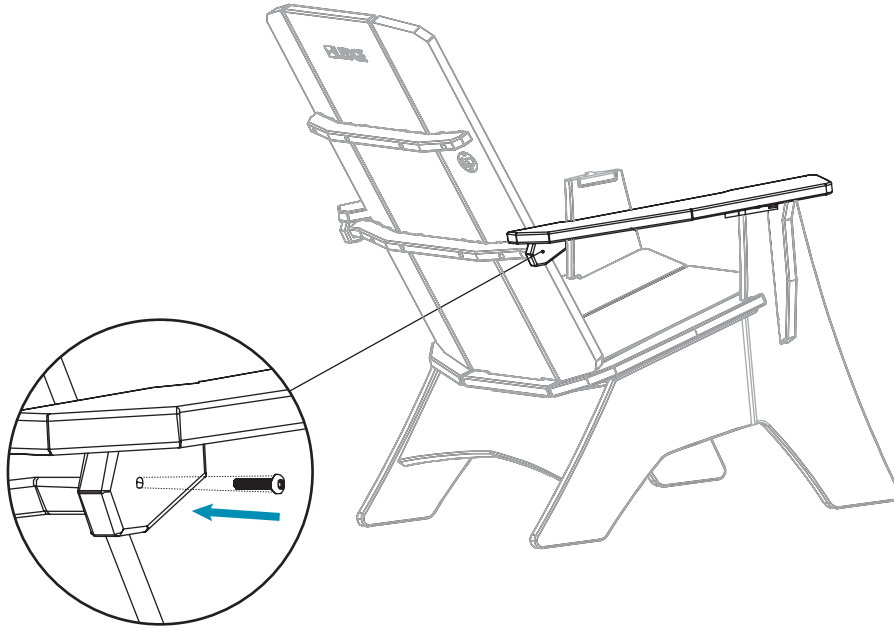

CLEANING AND CARE

- For routine cleaning, use water and a gentle washcloth or microfiber towel.
- For deep cleaning, use water, mild detergent and a soft-bristle brush.
- If power washing is desired, start with a low PSI at least 3ft away from the furniture. While power washing, check often to ensure no inscription is being made on the furniture.

PARTY TRICK

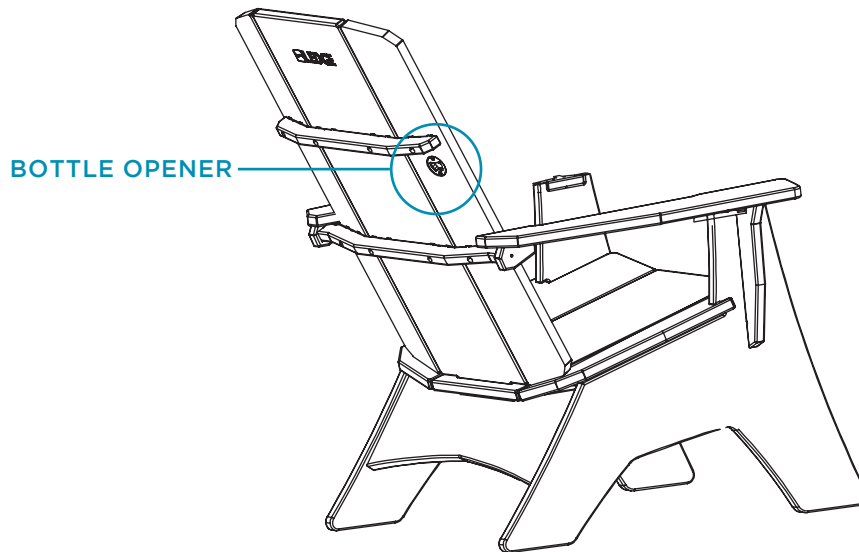
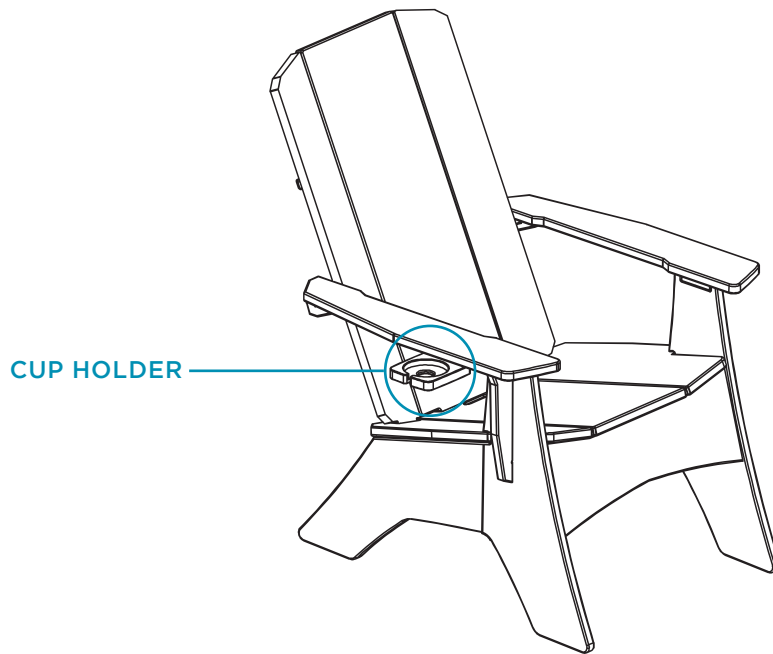

SHARE YOUR MEANINGFUL MOMENTS WITH US

#LEDGELIFE